

## BON JOUR VERSAILLES SMALL

Designed by Philippe Starck, 2017

F1042057

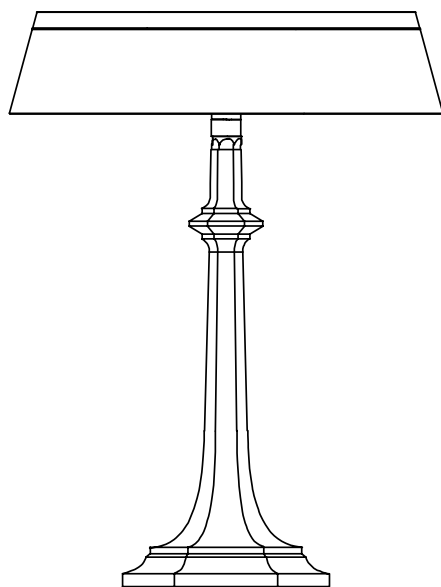

## BON JOUR VERSAILLES SMALL

EN

F1042057

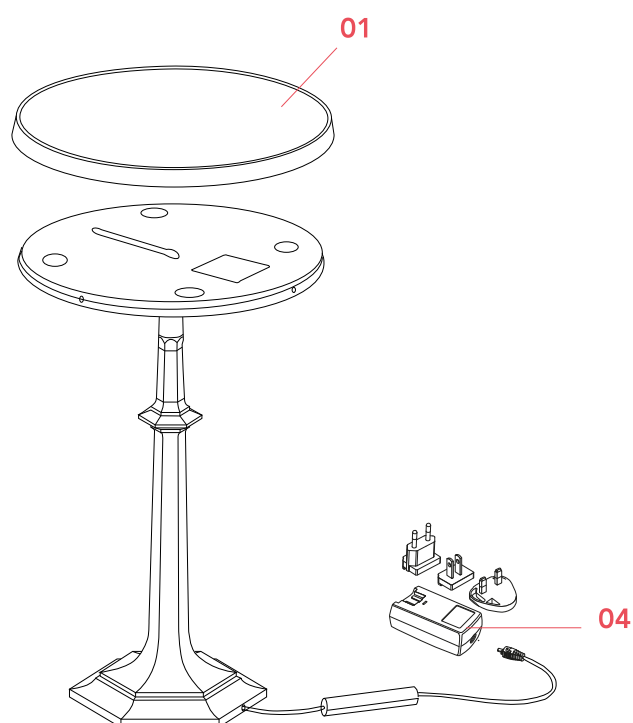

**01. RF25460** – Top cover chrome assembly

**04. RF3320200** – Plug kit + driver spare part

**BON JOUR VERSAILLES SMALL**  
F1042057

**EN**

**RF25460**

TOP COVER CHROME ASSEMBLY



WARNING! When installing and whenever acting on the appliance, ensure that the power supply has been switched off.  
For the installation of the spare-part, it is necessary to consult a qualified electrician.

©2021 Flos - All rights reserved - [www.flos.com](http://www.flos.com)  
Flos reserves the right to introduce any changes to its own models, without prior notice.

**BON JOUR VERSAILLES SMALL**  
F1042057

EN

## RF25460

TOP COVER CHROME ASSEMBLY

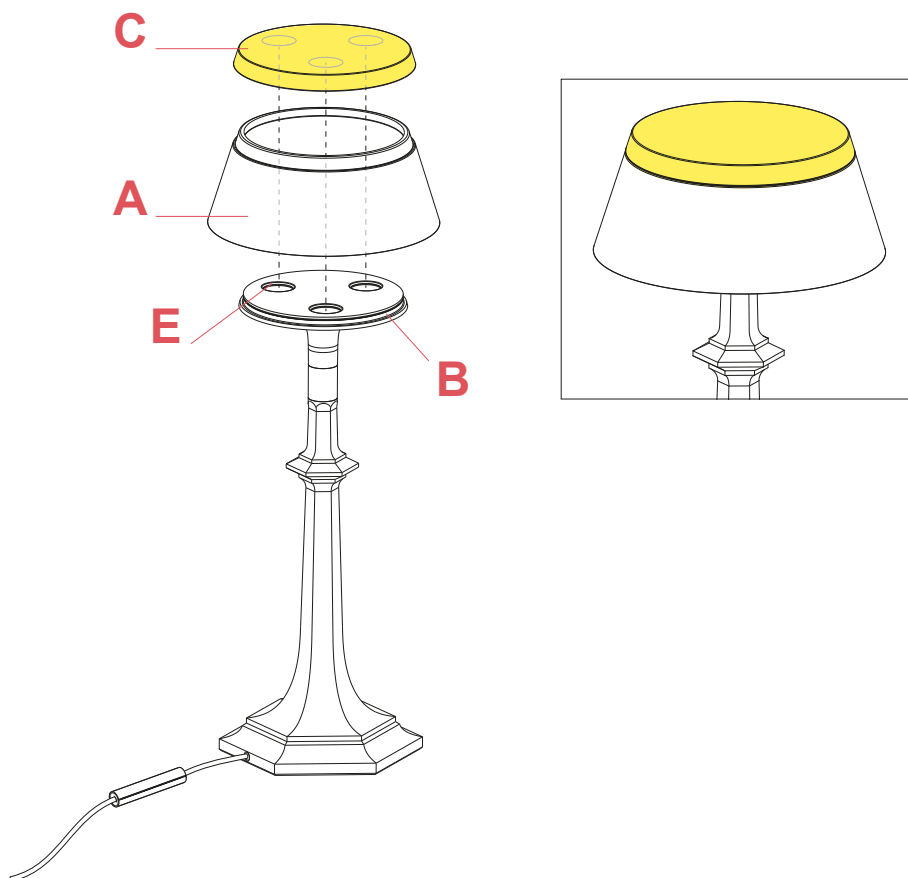

Fig.1

Support the lampshade (A) (Optional, not included) on the device body's profile (B); mount the TOP COVER (C) on the device body making sure you accurately position the three magnet disks (D) in their housings in the body (E) so that the TOP COVER (C) on completion of the assembly uniformly adheres to the body's profile (detail Pic.1 D).

**WARNING!** When installing and whenever acting on the appliance, ensure that the power supply has been switched off.  
For the installation of the spare-part, it is necessary to consult a qualified electrician.

**BON JOUR VERSAILLES SMALL**  
F1042057

**EN**

## RF3320200

PLUG KIT + DRIVER SPARE PART

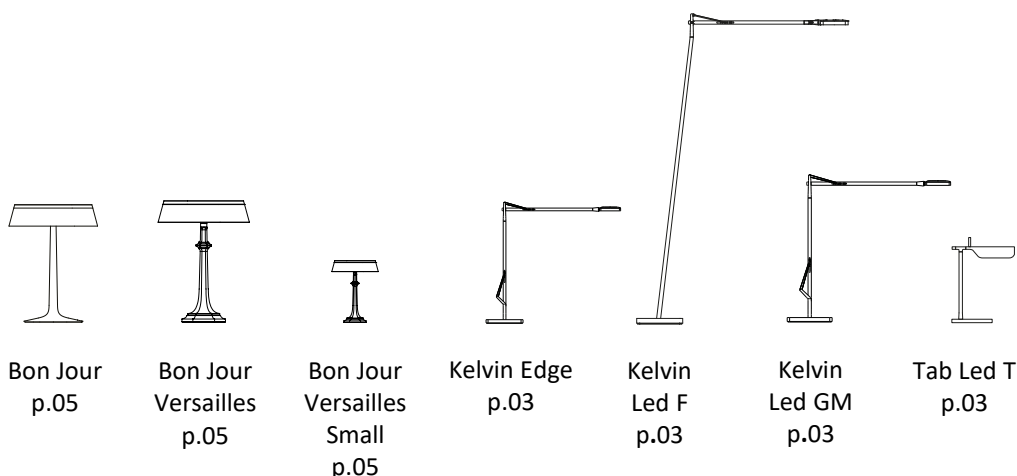

**WARNING!** When installing and whenever acting on the appliance, ensure that the power supply has been switched off.  
For the installation of the spare-part, it is necessary to consult a qualified electrician.

**BON JOUR VERSAILLES SMALL**  
F1042057**EN****RF3320200**

PLUG KIT + DRIVER SPARE PART

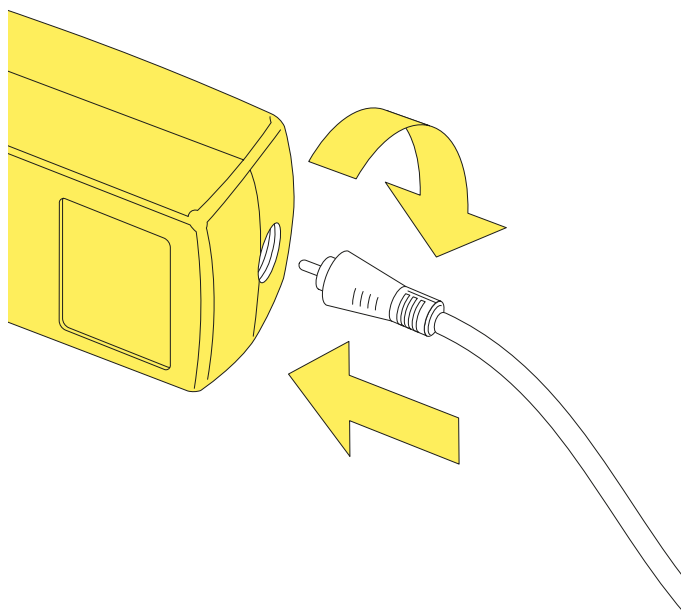

Fig.1

Insert the plug into the driver unit by using the guides snap it inside its apposite slot (use the correct type of plug for the area in which the device must be installed), connect the plug to the feeder unit locking it in by rotating it 90° clockwise.

WARNING! When installing and whenever acting on the appliance, ensure that the power supply has been switched off.  
For the installation of the spare-part, it is necessary to consult a qualified electrician.