

SERENA

Designed by Patricia Urquiola, 2015

F6582054

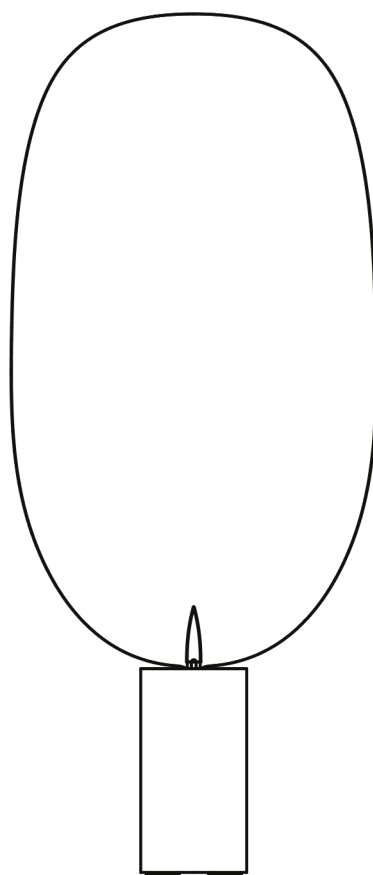

SERENA

F6582054

EN

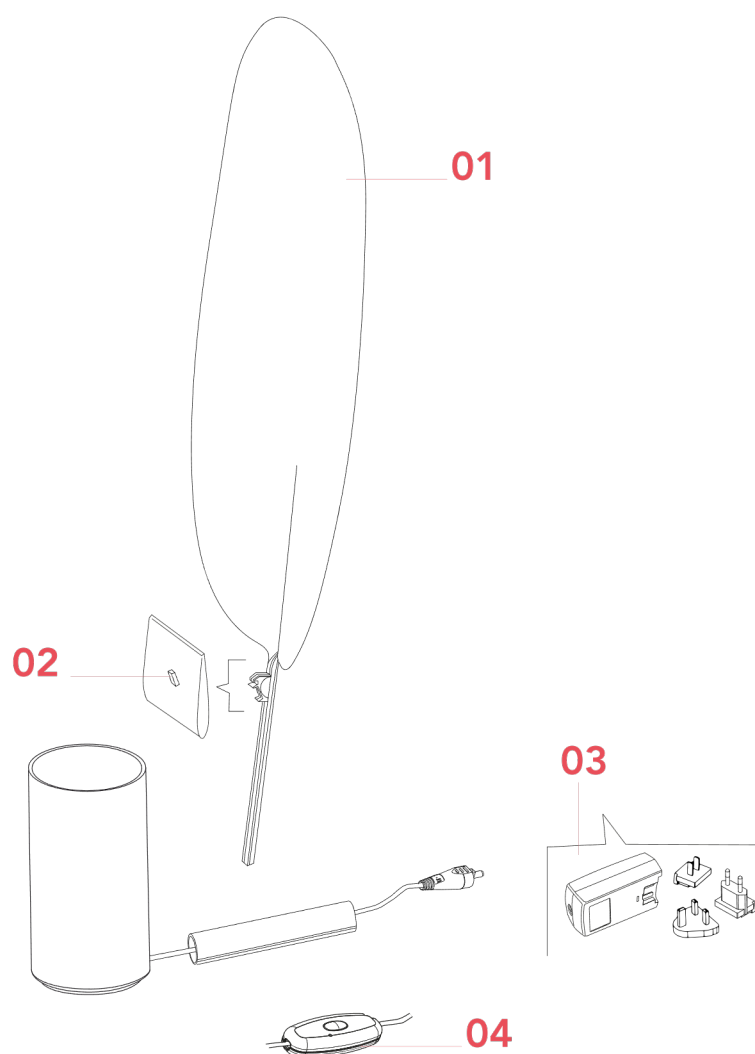

- 01. F6581054 – Anodized aluminum leaf-reflector
- 02. RF6580100 – Kit with magnet for reflector
- 03. RF3320100 – Black Plug kit & driver
- 04. RF6605100 – Jack plug with coaxial cable and old dimmer

SERENA F6582054

EN

F6581054

ANODIZED ALUMINUM LEAF-REFLECTOR



WARNING! When installing and whenever acting on the appliance, ensure that the power supply has been switched off.
For the installation of the spare-part, it is necessary to consult a qualified electrician.

©2021 Flos - All rights reserved - www.flos.com
Flos reserves the right to introduce any changes to its own models, without prior notice.

SERENA F6582054

EN

F6581054

ANODIZED ALUMINUM LEAF-REFLECTOR

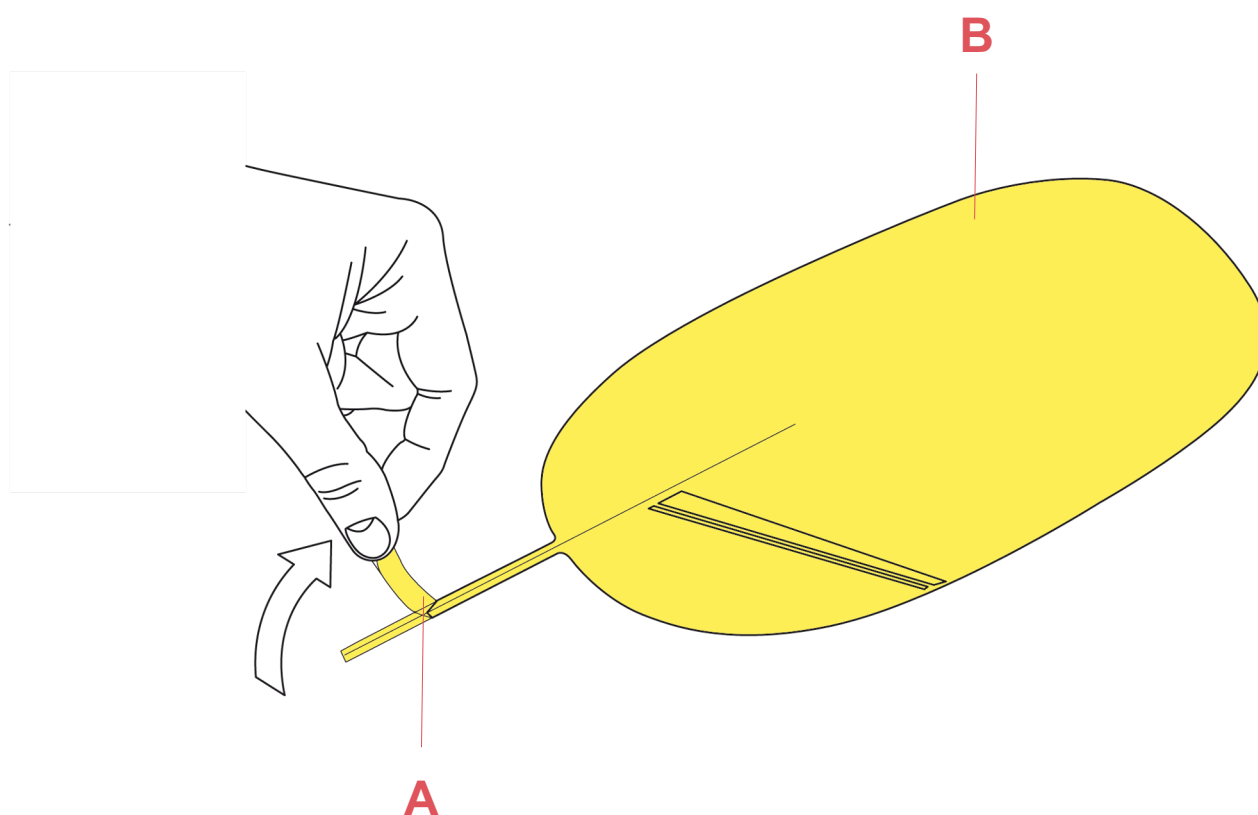

Fig.1

Remove the protective film (A) from the leaf (B) starting from the stem as shown in the figure.

WARNING! When installing and whenever acting on the appliance, ensure that the power supply has been switched off.
For the installation of the spare-part, it is necessary to consult a qualified electrician.

SERENA F6582054

EN

F6581054

ANODIZED ALUMINUM LEAF-REFLECTOR

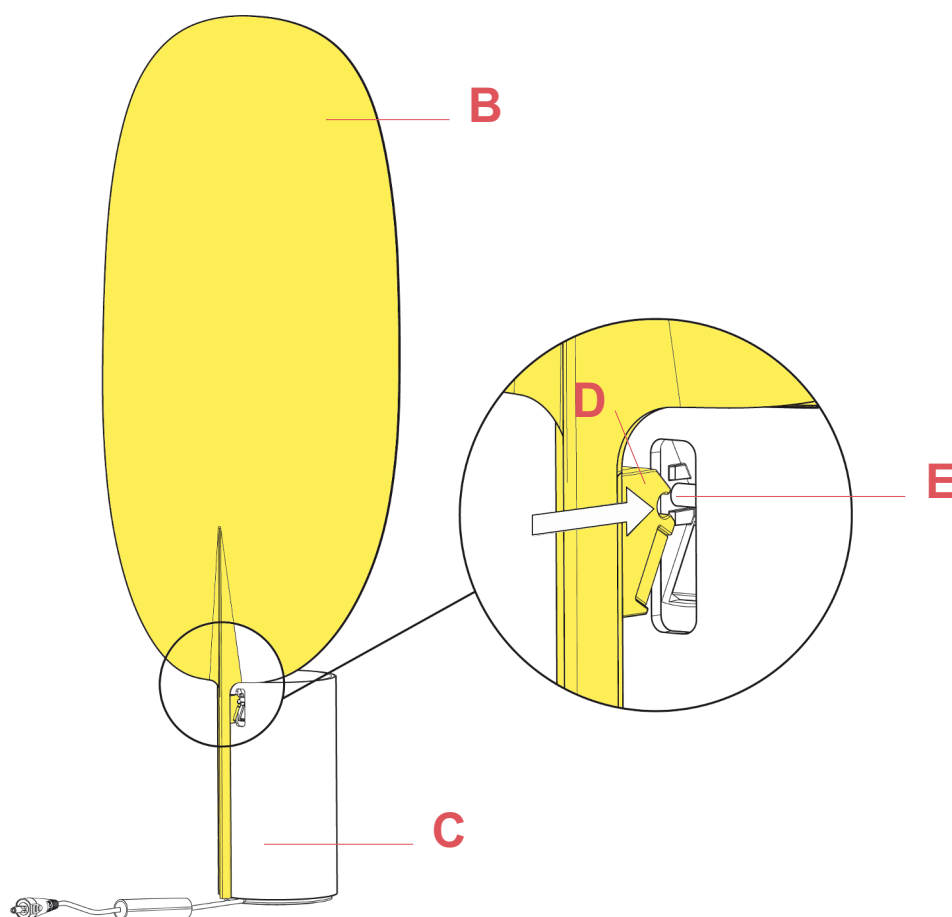

Fig.2

Assemble the leaf (B) onto the base (C) inserting the leaf's fastening clip (D) onto the base's pin (E).

WARNING! When installing and whenever acting on the appliance, ensure that the power supply has been switched off. For the installation of the spare-part, it is necessary to consult a qualified electrician.

SERENA F6582054

EN

F6581054

ANODIZED ALUMINUM LEAF-REFLECTOR

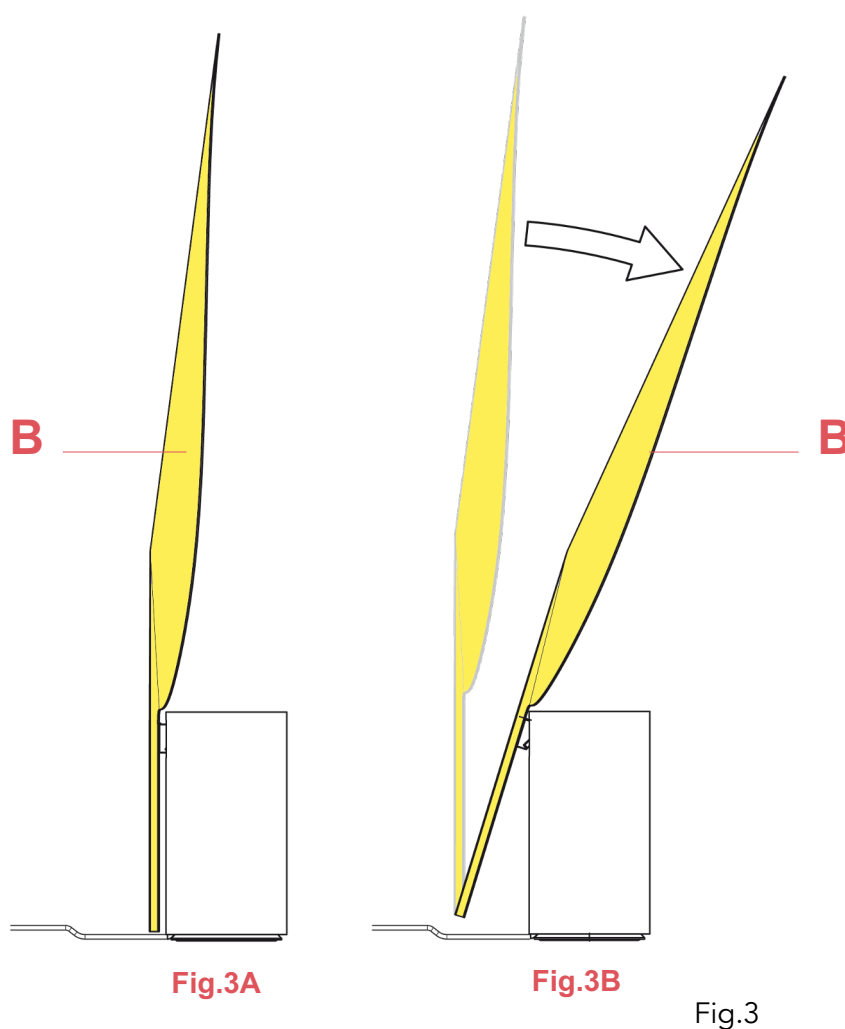

Fig.3

The leaf (B) can work in a position perpendicular to the surface (Fig.3A) or in a tilted position (Fig.3B).

WARNING! When installing and whenever acting on the appliance, ensure that the power supply has been switched off. For the installation of the spare-part, it is necessary to consult a qualified electrician.

SERENA F6582054

EN

RF6580100

KIT WITH MAGNET FOR REFLECTOR



WARNING! When installing and whenever acting on the appliance, ensure that the power supply has been switched off.
For the installation of the spare-part, it is necessary to consult a qualified electrician.

©2021 Flos - All rights reserved - www.flos.com
Flos reserves the right to introduce any changes to its own models, without prior notice.

SERENA F6582054

EN

RF6580100

KIT WITH MAGNET FOR REFLECTOR

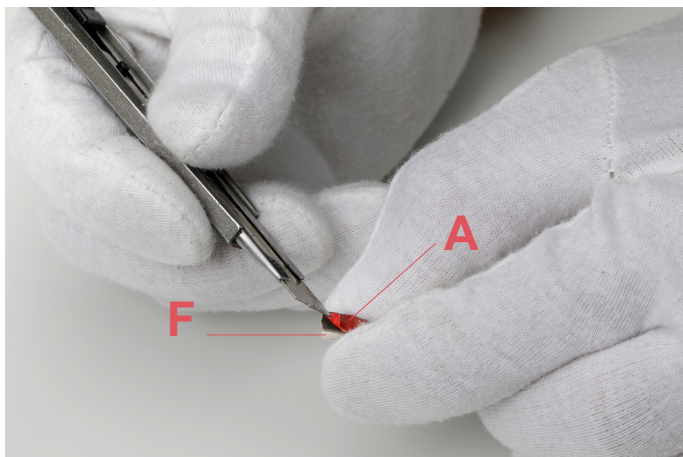

Fig.1

Remove the film (A) from the double tap present on the magnet (F).



Fig.2

Stick the magnet (F) in its apposite slot.

WARNING! When installing and whenever acting on the appliance, ensure that the power supply has been switched off.
For the installation of the spare-part, it is necessary to consult a qualified electrician.

©2021 Flos - All rights reserved - www.flos.com
Flos reserves the right to introduce any changes to its own models, without prior notice.

SERENA F6582054

EN

RF6580100

KIT WITH MAGNET FOR REFLECTOR

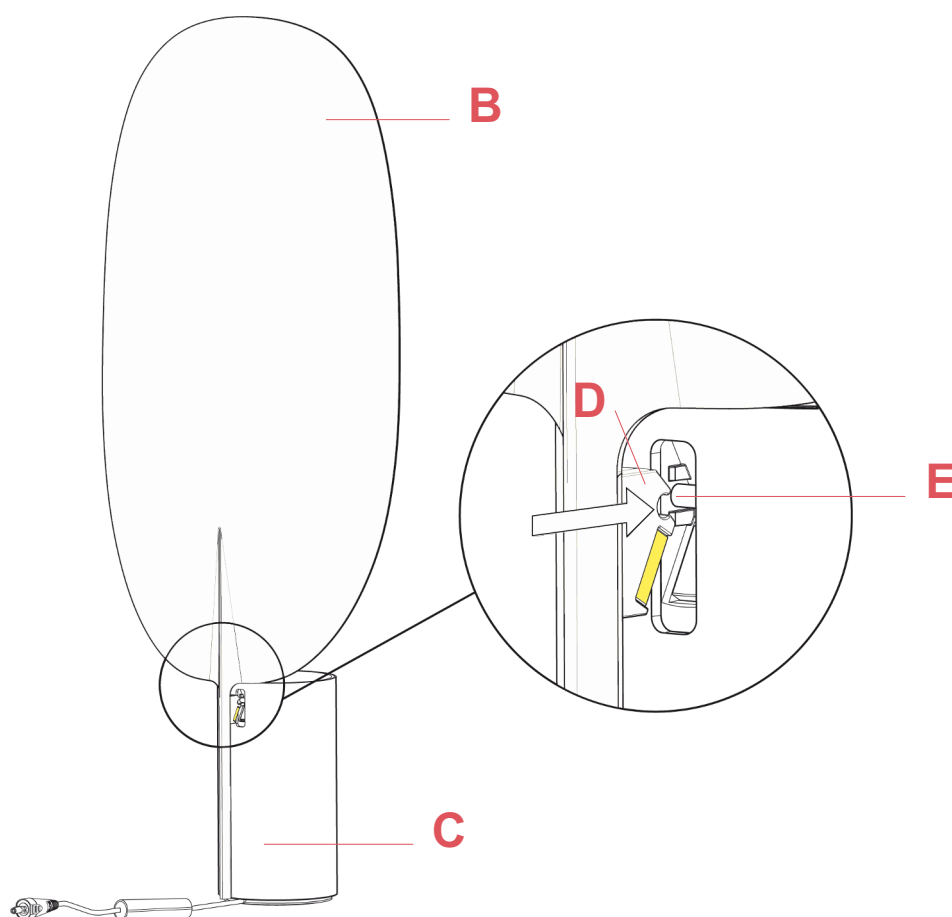

Fig.3

Assemble the leaf (B) onto the base (C) inserting the leaf's fastening clip (D) onto the base's pin (E).

WARNING! When installing and whenever acting on the appliance, ensure that the power supply has been switched off. For the installation of the spare-part, it is necessary to consult a qualified electrician.

SERENA F6582054

EN

RF3320100

BLACK PLUG KIT & DRIVER

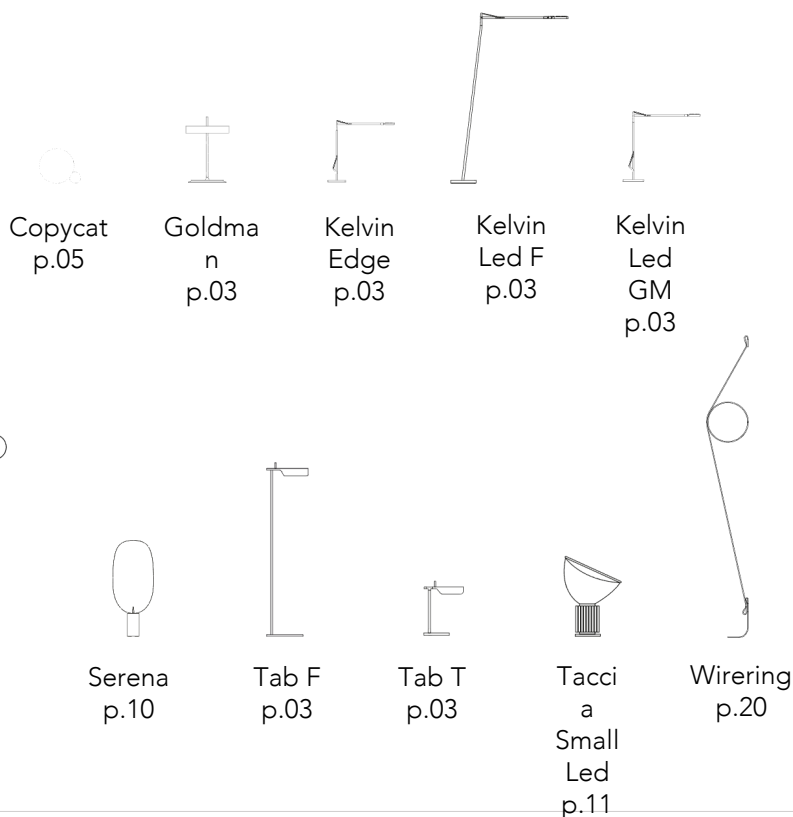

WARNING! When installing and whenever acting on the appliance, ensure that the power supply has been switched off. For the installation of the spare-part, it is necessary to consult a qualified electrician.

SERENA F6582054

EN

RF3320100

BLACK PLUG KIT & DRIVER

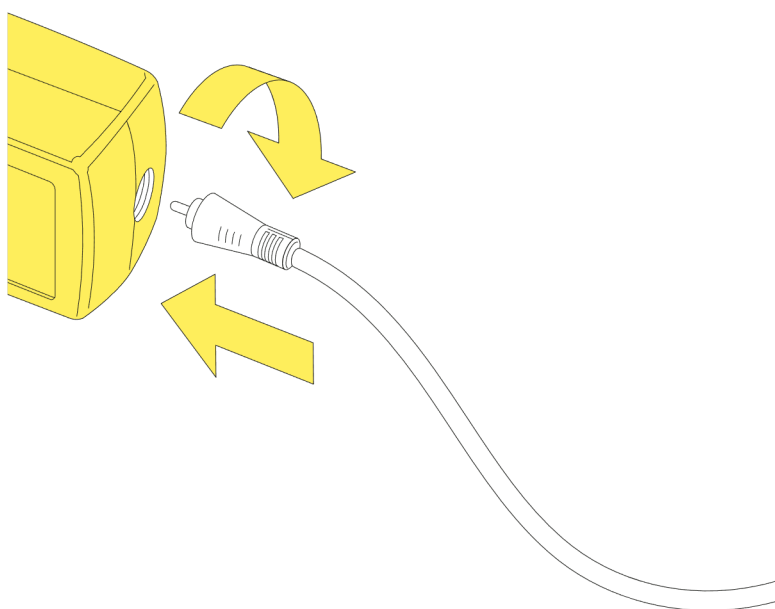

Fig.1

Insert the plug into the power unit. By using the guides, snap the plug inside its apposite slot (use the correct type of plug for the country in which the device must be installed).

WARNING! When installing and whenever acting on the appliance, ensure that the power supply has been switched off. For the installation of the spare-part, it is necessary to consult a qualified electrician.

©2021 Flos - All rights reserved - www.flos.com
Flos reserves the right to introduce any changes to its own models, without prior notice.

SERENA F6582054

EN

RF6605100

JACK PLUG WITH COAXIAL CABLE AND OLD DIMMER



Copycat
p.07



Serena
p.12



Taccia
Small
Led
p.08

WARNING! When installing and whenever acting on the appliance, ensure that the power supply has been switched off. For the installation of the spare-part, it is necessary to consult a qualified electrician.

SERENA F6582054

EN

RF6605100

JACK PLUG WITH COAXIAL CABLE AND OLD DIMMER



Fig.1

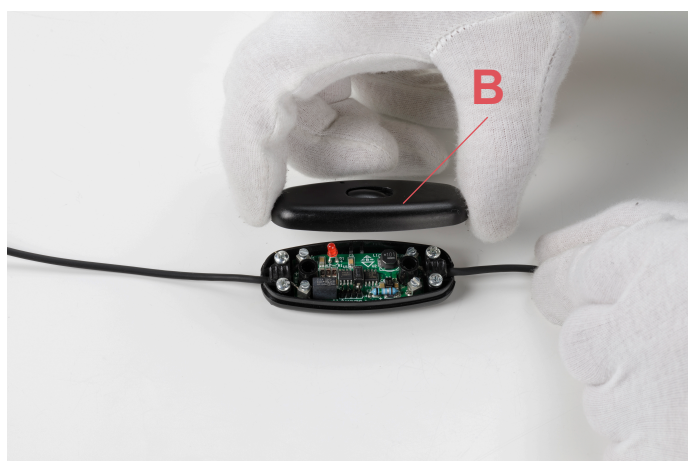

Fig.2

Unfasten the 2 screws (A) from underneath the dimmer and remove the dimmer cover (B).

WARNING! When installing and whenever acting on the appliance, ensure that the power supply has been switched off. For the installation of the spare-part, it is necessary to consult a qualified electrician.

SERENA F6582054

EN

RF6605100

JACK PLUG WITH COAXIAL CABLE AND OLD DIMMER

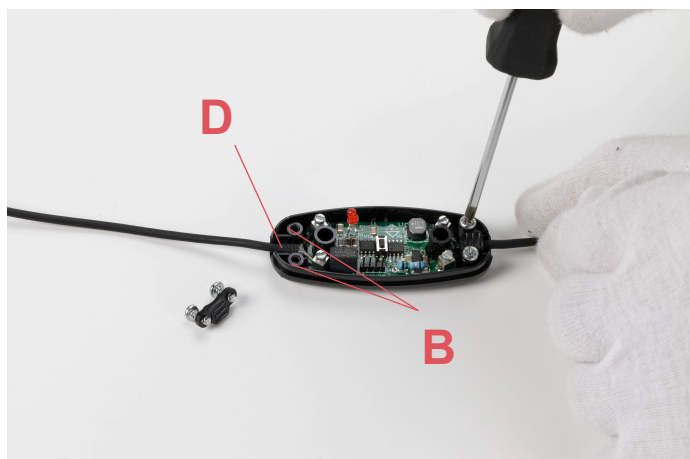

Fig.3

Unfasten the 2 screws (C) of the cable clamp (D) and disconnect the wires from the terminal box (F) through a tiny flat headed screw driver.

Assemble now the new spare-part:

Unfasten the 2 screws (A) from underneath the dimmer and remove the dimmer cover (B).

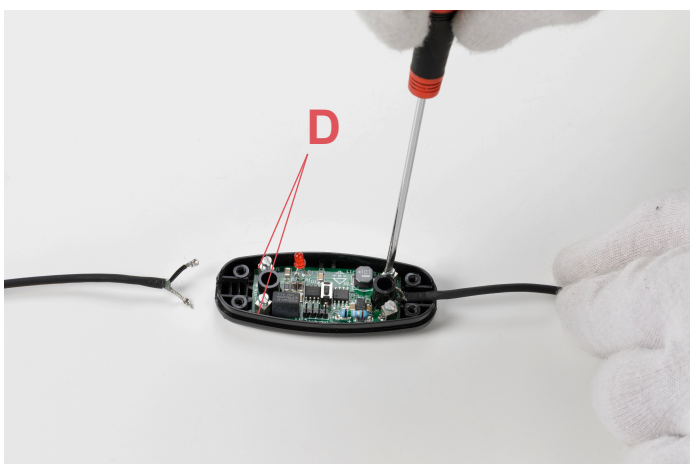

Fig.4

Connect the electrical wires to the terminal (F) respecting the polarities of the dimmer. Position the cable clamp (D) and fasten back the screws (C).

Close the dimmer by positioning the cover (B) and fastening the 2 screws (A).

WARNING! When installing and whenever acting on the appliance, ensure that the power supply has been switched off. For the installation of the spare-part, it is necessary to consult a qualified electrician.