

TACCIA SMALL

Designed by Achille and Pier Giacomo Castiglioni, 1962

F6604030

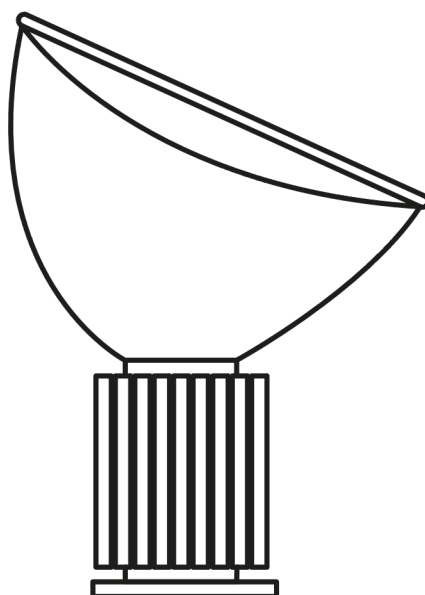

TACCIA SMALL

F6604030

EN

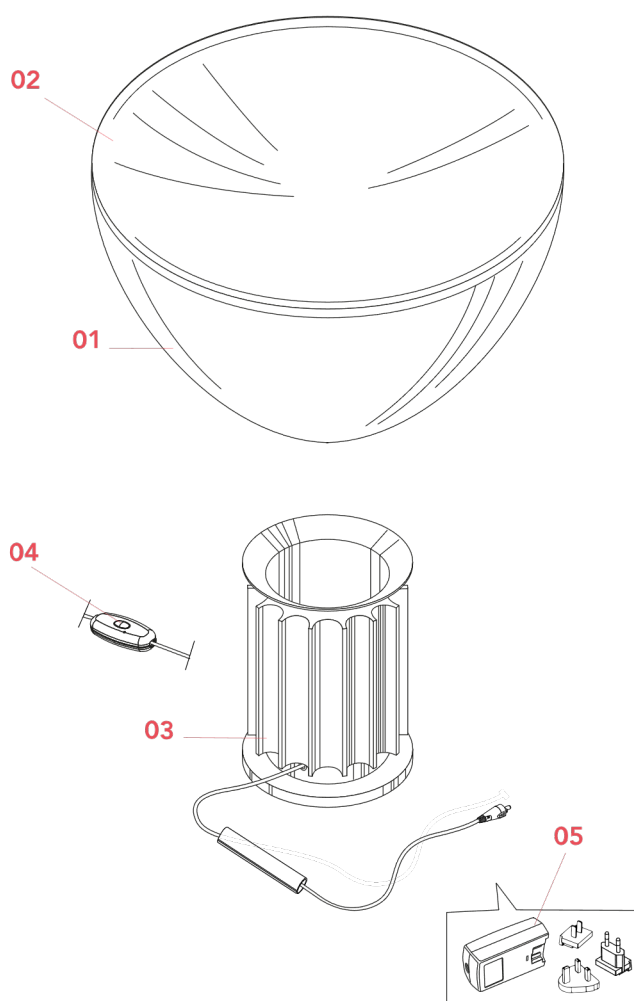

- 01. F6606000 – Glass diffuser with reflector
- 02. RF24886 – White reflector
- 03. F6605030 – Black base with old dimmer
- 04. RF6605100 – Jack plug with coaxial cable and old dimmer
- 05. RF3320100 – Black Plug kit & driver

TACCIA SMALL F6604030

EN

F6606000

GLASS DIFFUSER AND REFLECTOR



WARNING! When installing and whenever acting on the appliance, ensure that the power supply has been switched off.
For the installation of the spare-part, it is necessary to consult a qualified electrician.

©2021 Flos - All rights reserved - www.flos.com
Flos reserves the right to introduce any changes to its own models, without prior notice.

TACCIA SMALL F6604030

EN

F6606000

GLASS DIFFUSER AND REFLECTOR

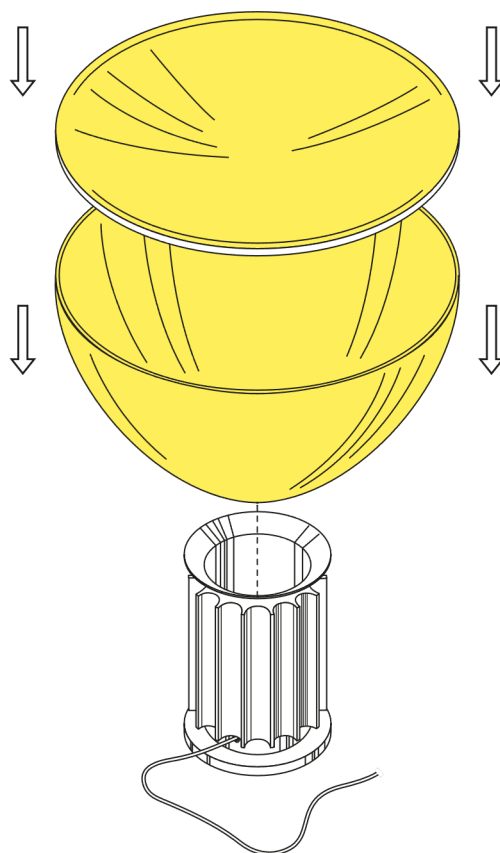

Fig.1

Position the diffuser (B) and the reflector (A) on the base (C).

WARNING! When installing and whenever acting on the appliance, ensure that the power supply has been switched off.
For the installation of the spare-part, it is necessary to consult a qualified electrician.

TACCIA SMALL F6604030

EN

RF24886

WHITE REFLECTOR



WARNING! When installing and whenever acting on the appliance, ensure that the power supply has been switched off.
For the installation of the spare-part, it is necessary to consult a qualified electrician.

©2021 Flos - All rights reserved - www.flos.com

Flos reserves the right to introduce any changes to its own models, without prior notice.

TACCIA SMALL F6604030

EN

RF24886

WHITE REFLECTOR

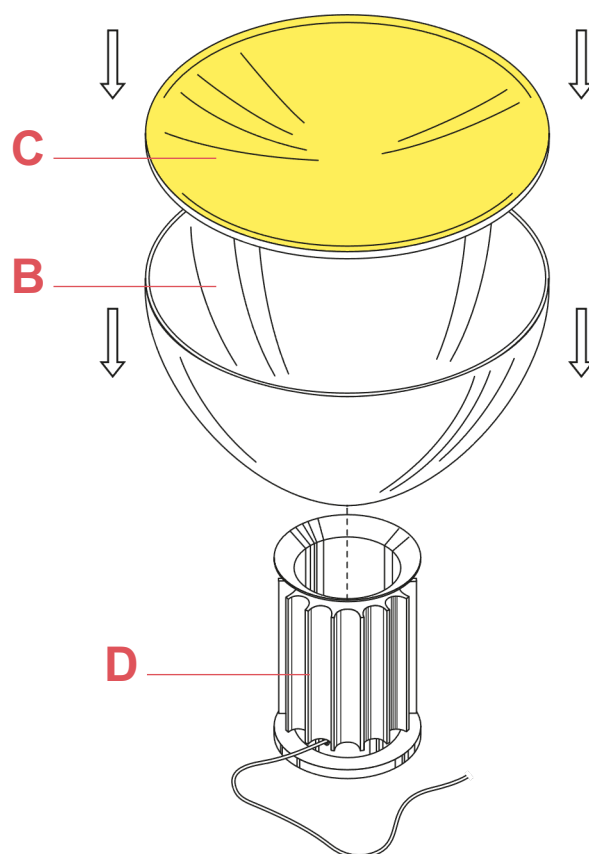

Fig.1

Position the reflector (C) on the diffuser (B).

WARNING! When installing and whenever acting on the appliance, ensure that the power supply has been switched off.
For the installation of the spare-part, it is necessary to consult a qualified electrician.

TACCIA SMALL F6604030

EN

F6604030

TACCIA SMALL LED BASE WITH OLD DIMMER



WARNING! When installing and whenever acting on the appliance, ensure that the power supply has been switched off.
For the installation of the spare-part, it is necessary to consult a qualified electrician.

©2021 Flos - All rights reserved - www.flos.com
Flos reserves the right to introduce any changes to its own models, without prior notice.

TACCIA SMALL F6604030

EN

RF6605100

JACK PLUG WITH COAXIAL CABLE AND OLD DIMMER



Copycat
p.07



Serena
p.12



Taccia
Small
Led
p.08

WARNING! When installing and whenever acting on the appliance, ensure that the power supply has been switched off. For the installation of the spare-part, it is necessary to consult a qualified electrician.

TACCIA SMALL F6604030

EN

RF6605100

JACK PLUG WITH COAXIAL CABLE AND OLD DIMMER



Fig.1

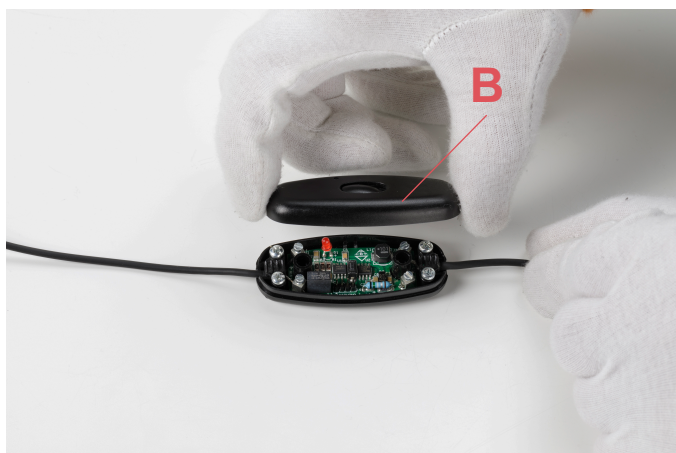

Fig.2

Unfasten the 2 screws (A) from underneath the dimmer and remove the dimmer cover (B).

WARNING! When installing and whenever acting on the appliance, ensure that the power supply has been switched off. For the installation of the spare-part, it is necessary to consult a qualified electrician.

TACCIA SMALL F6604030

EN

RF6605100

JACK PLUG WITH COAXIAL CABLE AND OLD DIMMER

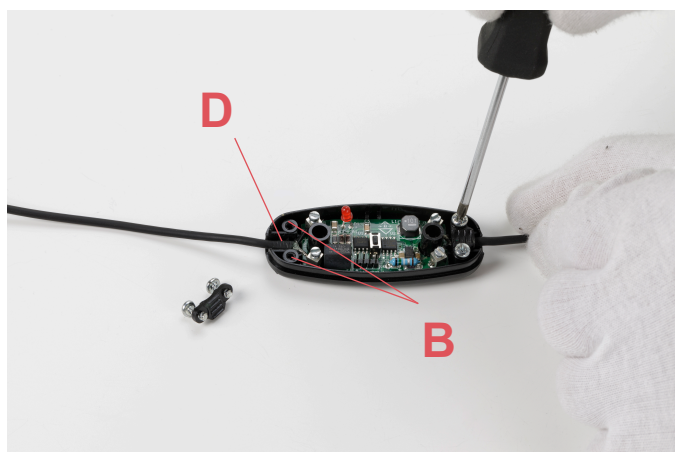

Fig.3

Unfasten the 2 screws (C) of the cable clamp (D) and disconnect the wires from the terminal box (F) through a tiny flat headed screw driver.

Assemble now the new spare-part:

Unfasten the 2 screws (A) from underneath the dimmer and remove the dimmer cover (B).

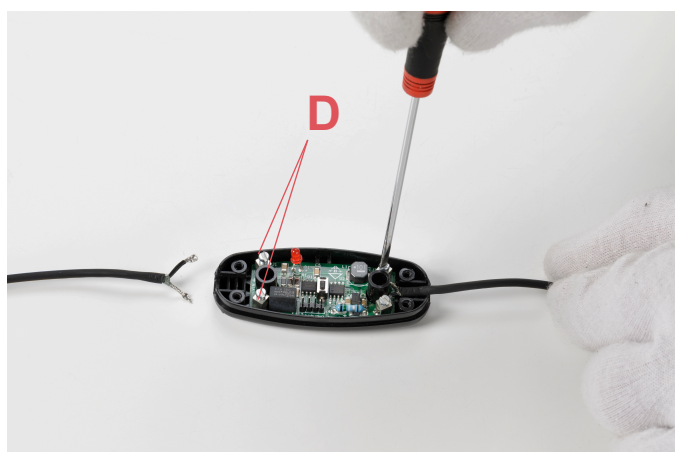

Fig.4

Connect the electrical wires to the terminal (F) respecting the polarities of the dimmer. Position the cable clamp (D) and fasten back the screws (C).

Close the dimmer by positioning the cover (B) and fastening the 2 screws (A)

WARNING! When installing and whenever acting on the appliance, ensure that the power supply has been switched off. For the installation of the spare-part, it is necessary to consult a qualified electrician.

TACCIA SMALL F6604030

EN

RF3320100

PLUG KIT + DRIVER SPARE PART



Copycat
p.05

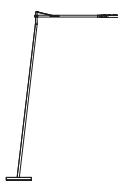

Goldman
p.03

Kelvin
Edge
p.03

Kelvin
Led F
p.03



Kelvin
Led GM
p.03



Ok
p.38

Serena
p.10

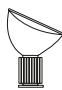
Tab F
p.03

Tab T
p.03

Taccia
Small
Led
p.11

Wirering
p.20

WARNING! When installing and whenever acting on the appliance, ensure that the power supply has been switched off. For the installation of the spare-part, it is necessary to consult a qualified electrician.

TACCIA SMALL F6604030

EN

RF3320100

PLUG KIT + DRIVER SPARE PART

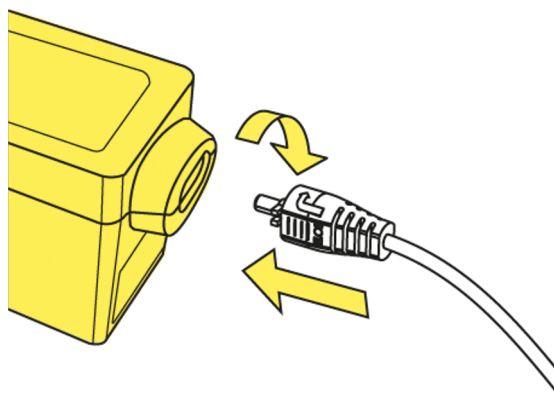

Fig.1

Insert the plug into the driver unit by using the guides snap it inside its apposite slot (use the correct type of plug for the area in which the device must be installed), connect the plug to the feeder unit locking it in by rotating it 90° clockwise.

WARNING! When installing and whenever acting on the appliance, ensure that the power supply has been switched off.
For the installation of the spare-part, it is necessary to consult a qualified electrician.