

# NOVA Wood meeting and coffee tables



## FEATURES

- Easy to assemble and disassemble - "metal to metal" construction
- Just one tool for assembling (DIN911 S5)
- Bolted connections (without screws)

## QUALITY STANDARD

- LST EN 527-1:2011
- LST EN 527-2:2003
- All desks meet the requirements of the LST EN 527-3:2003 standard

## TECHNICAL INFORMATION

### Tabletop

- 25 mm MFC (melamine) with 2 mm ABS edging;
- 26 mm MDF covered in HPL with sloping painted edges;
- Sloping painted edges: white or black colour;
- The corners of sloping desktop are rounded: R100 mm;
- 10 mm gap between the legs and the desktop.

### Metal beam

- Metal tube - 40x20 mm;
- With welded metal plates for leg fixing;
- Powder coated metal.

### Legs (meeting tables)

- Lacquered and stained natural ash solid wood;
- Glued wood construction;
- With metal inserts for fixing;
- Plastic feet with height levelling (+10 mm).

### Central leg (solid wood leg fixed into metal tube)

- Lacquered and stained natural ash solid wood;
- Glued wood construction;
- With metal inserts for fixing;
- Plastic feet with height levelling (+10 mm);
- Metal tube: 80x40 mm, powder coated metal.

### Legs (coffee tables)

- Lacquered and stained natural ash solid wood;
- Glued wood construction;
- Powder coated metal.
- Plastic feet with height levelling (+10 mm).



## Electrical and cable management

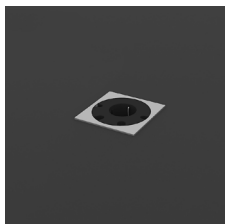

With Götessons power sockets



With insert and Götessons power sockets



With insert and grommets for wire management

## Inserts

- Lacquered and stained;
- 25 mm chipboard covered in ash wood veneer with 1.5mm edging (for plain edges desktops);
- 26mm MDF covered in ash wood veneer with 1.5mm edging (for sloping edges desktops).

## Grommets

- Lacquered and stained;
- 9mm MDF covered in ash wood veneer with painted edges.

## Edge type



ABS edge (melamine)



Sloping edge (HPL)

## Cable tray (included)

- Dimensions: 500x100, H=110mm (except for CNM182 and CNM185: 1100x100, H=110 mm);
- Matches the colour of frame.

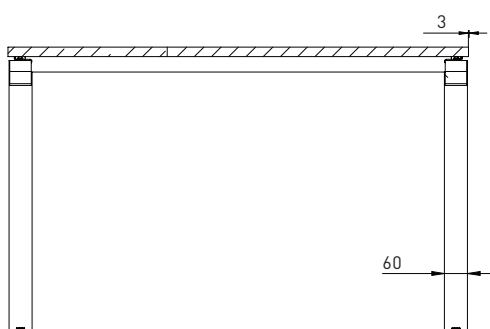

Table with melamine tabletop

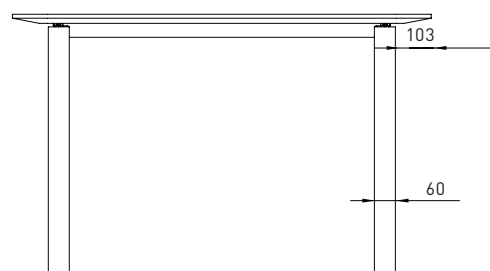
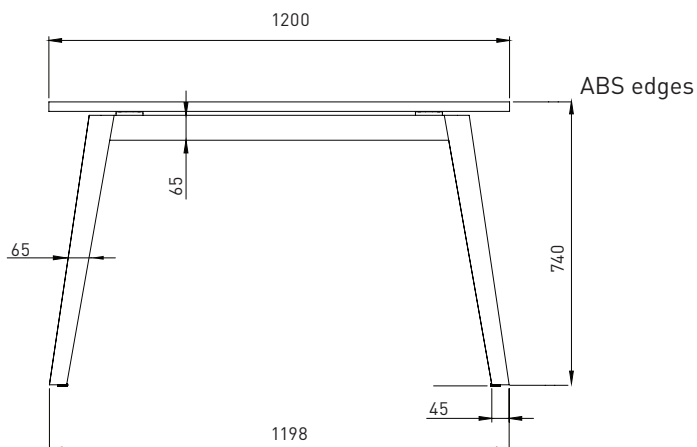
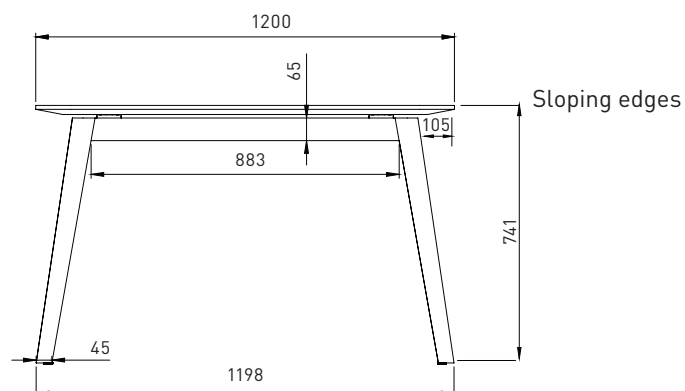
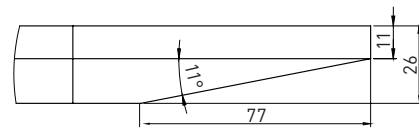
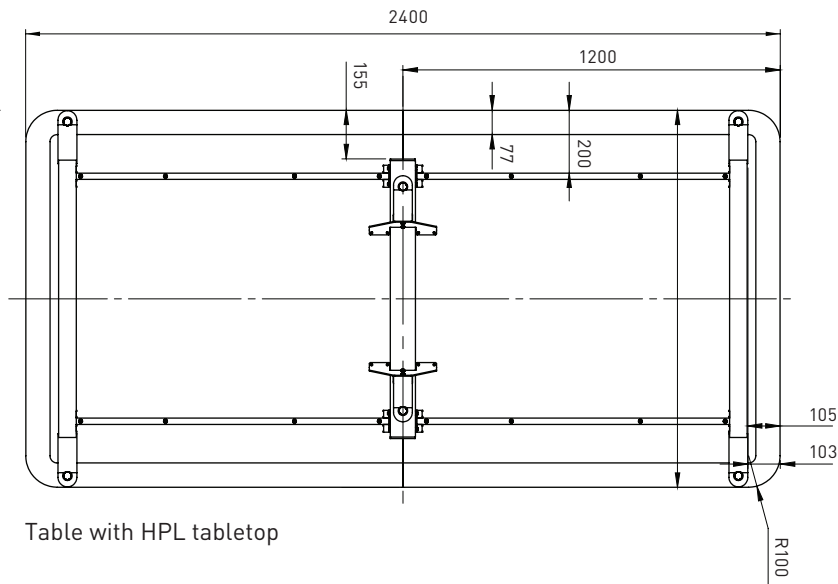

Table with HPL tabletop





Sloping edge

## MATERIALS

- Melamine: M1 (white), M1D2 (white with amber oak edges); N (grey);
- HPL: M1B02 (white with white painted edges), M1B01 (white with black painted edges), L6B01 (black with black painted edges);
- Metal: E (white), A (black), M (metallic), T1 (dark grey);
- Solid wood: W2 (ash stained light grey).

## RANGE

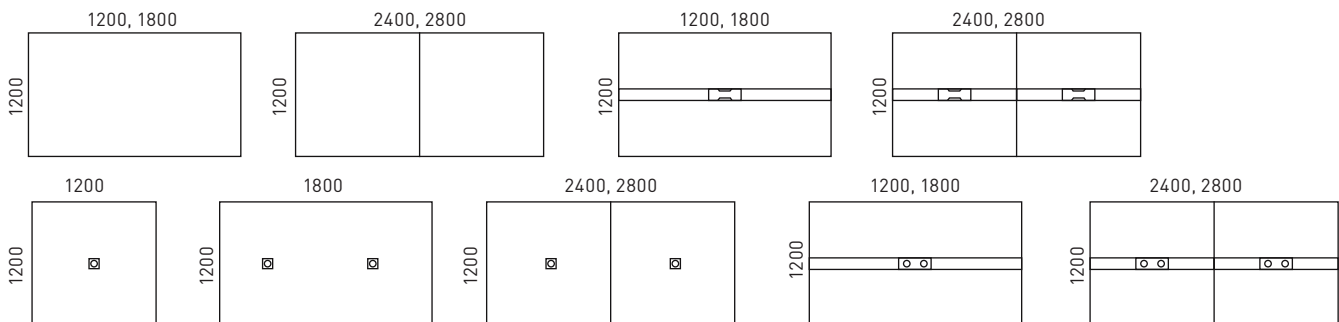

Meeting tables with melamine tabletop

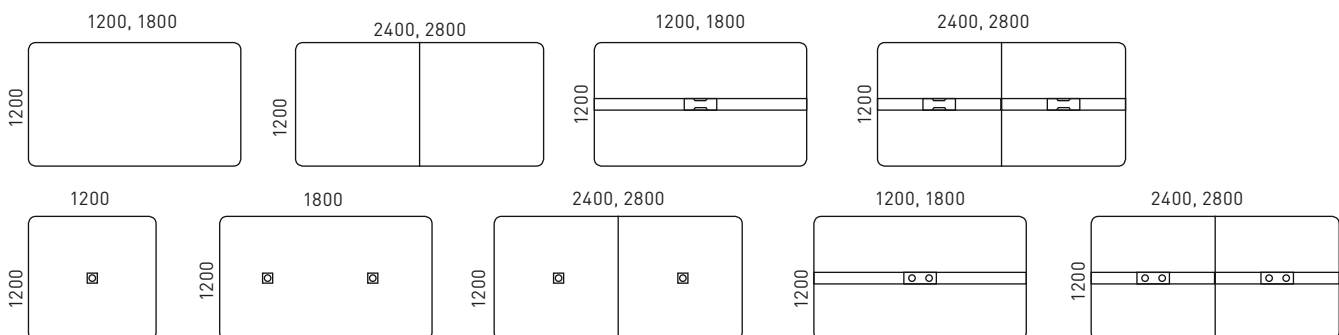

Meeting tables with HPL tabletop



Coffee tables with melamine tabletop

Coffee tables with HPL tabletop

## ORDERING EXAMPLE

## Code structure

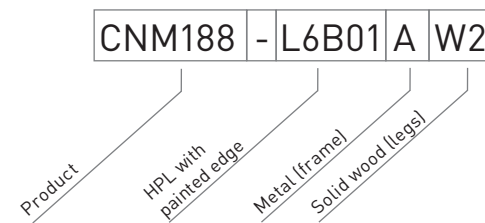
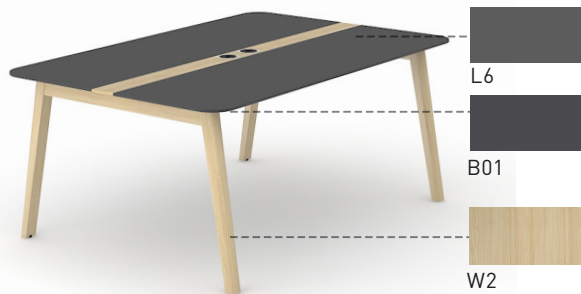
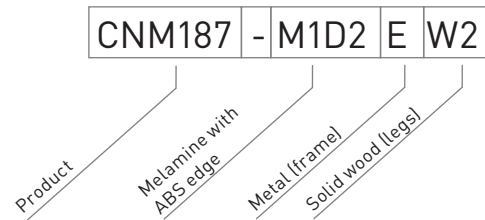

## Optional



Power socket blocks



Cable clips



Cable ducts